

Certified replacement bulbs for the microsunXL are available from Microsun. Call 937-552-2424 or visit us online at [microsun.com](http://microsun.com).

- PN 9080 - microsunXL Center LED Bulb
- PN 9085 - LED Side Socket Bulbs



### Care and Use Instructions:

- Do not open the module. There are no serviceable parts inside.
- Always unplug the lamp from the wall outlet before changing bulbs.
- Never leave any sockets empty when lamp is plugged in.
- Fabric shades should only be vacuumed. Do not attempt to wash or dry clean fabric shades.
- Wood, brass or other lamp bases should be cleaned with normal dusting. Do not use abrasive cleaners or chemicals on any lamp body.



**Caution: All wiring must be in accordance with national and local electrical codes. If you are unfamiliar with wiring, you should use a qualified electrician for this replacement procedure.**

Your microsunXL Lamp is under warranty for 5 years. Please reach out to us if you have any questions; we are happy to help.



7890 CENTER POINT 70 BLVD  
DAYTON, OH 45424

937-552-2424  
[microsun.com](http://microsun.com)



## Upgrade Kit Instruction Manual

*Upgrade your Microsun lamp to a microsunXL*

Congratulations on your purchase of a microsunXL upgrade set. This manual outlines step by step instructions to convert your existing Microsun lamp to a microsunXL.

Before starting your upgrade, verify you have all of the included materials listed below as well as the tools you will need.

**Materials List:** Control Module, Center Bulb (1), Side Bulbs (2), Wire Nuts (2), Set Screw, Allen Wrench and Wireless Dimmer

**Tools Required:** Safety Glasses, Wire Cutters, Wire Strippers



**CAUTION: Read the entire installation instruction manual before beginning installation and save the instructions.**

**See the instructional video on our Resource Center page:**



**CAUTION: To reduce the risk of electrical shock or injury to persons, observe the following guidelines:**

- Before starting unplug lamp cord from the electrical socket.
- Allow a few minutes for the light bulb to cool before removing it from the socket.
- Have a clean area to work which is free from obstacles and distractions.
- This unit is intended for indoor use only.
- If you are not comfortable with any aspect of installing your Control Module, consult a professional electrician.

STEP 1



Unpack and inspect the Control Module carefully to be sure no damage has occurred during shipment.

STEP 2



**STOP: Unplug your lamp!**

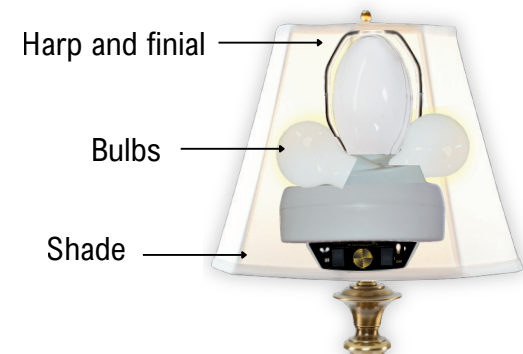

Remove your lamp shade, harp, finial and all three bulbs.

STEP 3



Carefully remove the felt covering or cut a small "X" in center of the felt large enough to pull the wires through or metal plate from the bottom of lamp base. Do not damage this cover as it will be reapplied later.

STEP 4

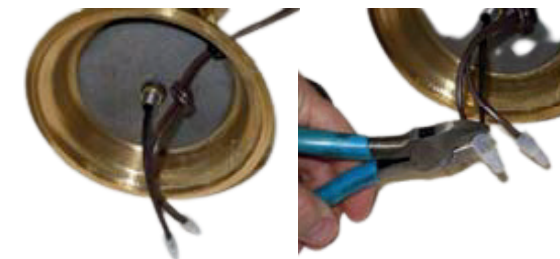

Cut both connectors off of the lamp cord.

STEP 5



Use the 5/64 Allen wrench to remove the set screw found just below the Control Module.

STEP 6



Hold the lamp housing and rotate the Control Module counter-clockwise until it is free from the lamp housing.

STEP 7

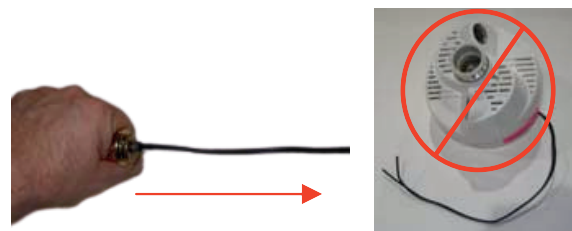

Remove and dispose of the old Control Module.

STEP 8

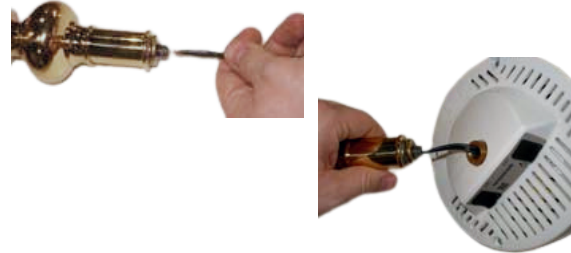

Thread the new Control Module wiring into the lamp rod. Pull the cord slowly from the bottom of lamp base.

STEP 9

**CAUTION:** Do not over tighten and do not cross thread the Control Module.



Hold the lamp housing and screw the Control Module onto the lamp rod by rotating it clockwise until it is snug in place.

STEP 10

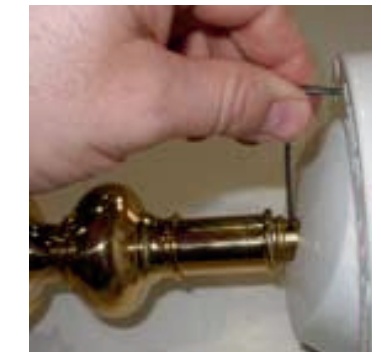

Rotate the control module in either direction so switches are facing forward. Do not over-tighten. Insert and tighten the included set screw.

STEP 11



Cut the Control Module wire so 3 inches of wire remain exposed below the lamp rod.

STEP 12



Separate the Control Module wire in two, and strip both ends to 1/2 inch. Strip both wires of the lamp cord to 1/2 inch.

STEP 13

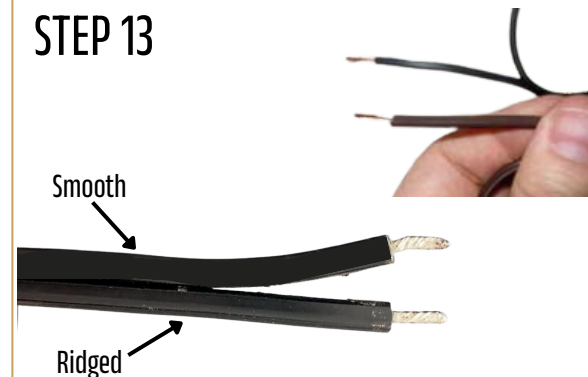

Locate the wires from the Control Module and the cord. Find the wire with a ridge or series of ridges on the insulation. It is helpful to use your finger to feel for the ridges.

STEP 14

**WARNING:** Wire nuts need to cover all exposed wires

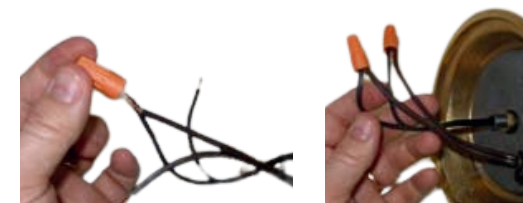

Wire nut the two wires with ridges together by twisting the wires together and then twist the nut clockwise on the wire. Then wire nut the other two non ridged wires together.

STEP 15

**NOTE:** Torchiere installations require both power switches to be set to the "ON" position prior to assembly.



Insert wires into base and reattach the bottom covering, if needed.